

**IMPORTANT INFORMATION**  
**A428 Black Cat to Caxton Gibbet improvement  
 scheme - working near you**

Our ref: A421FullClosure-TM-02/01/2024

National Highways  
 A428 Wintringham Site Office  
 St Neots Bypass (A428)  
 St Neots  
 Cambridgeshire  
 PE19 6FL

**A421 Full Weekend Closure**  
**Friday 12 January (9pm) to Monday 15 January (5am)**

**Reconstructed A421 central reservation**

From Monday 15 January, we will move the A421 eastbound traffic onto the reconstructed central reservation area on the approach to the Black Cat roundabout. The A421 westbound traffic will be restricted to one lane from the Black Cat to the end of our works area (approximately 1,200 meters or just over two minutes).

The new alignment means we can build the new slip roads and new Roxton Road overbridge, with minimal disruption.

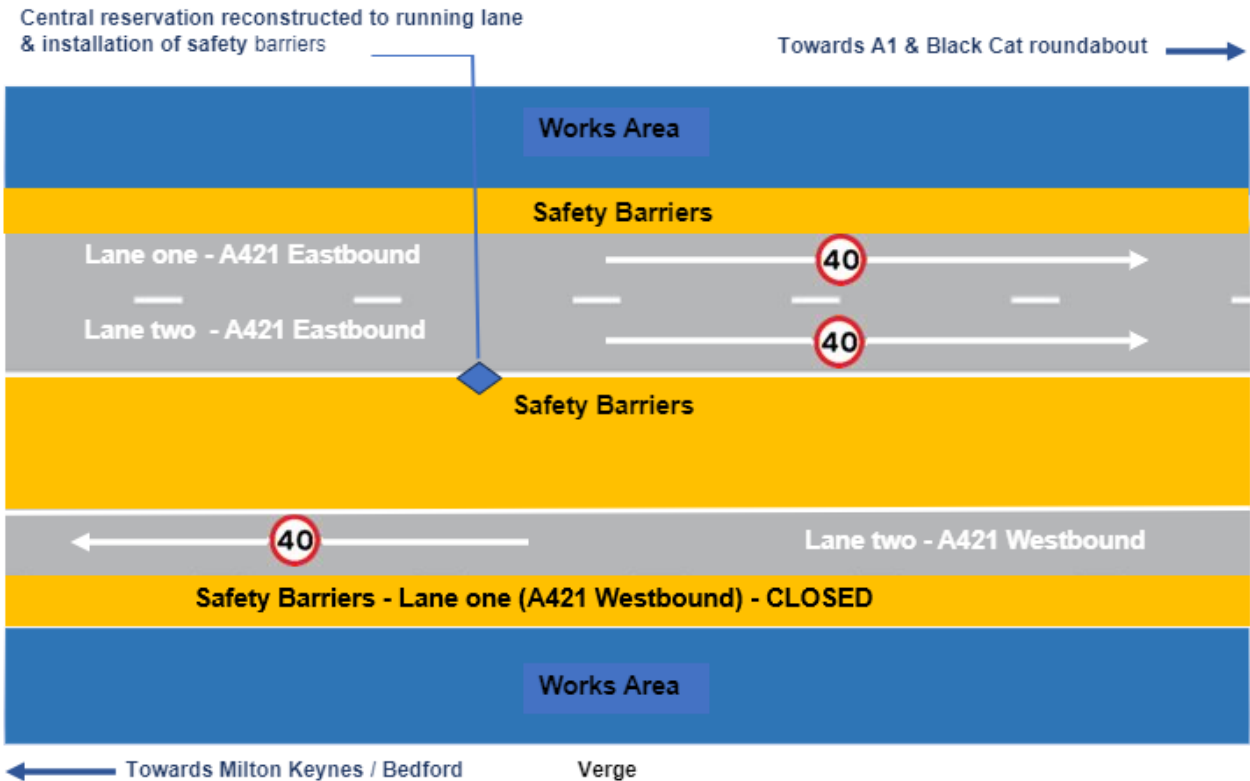

*New central reservation traffic alignment on the A421 westbound and eastbound*

### How will this affect me?

We are closing this stretch of the A421 westbound and eastbound to enable the transition of traffic to the new alignment, between Renhold and Black Cat roundabout from **9pm Friday 12 January to 5am Monday 15 January 2024**.

### The diversion route will be clearly signed, as follows:

**A421 eastbound:** eastbound traffic diverted via the A603 at Cardington to A1 northbound at Sandy to Black Cat roundabout.

**A421 westbound:** westbound traffic via the A1 Black Cat roundabout southbound to Sandy to the A603 to join the A421 westbound at Cardington.

Please plan your journey accordingly. Please also note that traffic approaching the closure location shortly before 9pm is likely to be subject to the diversion while the closure is put in place.

We apologise in advance for any inconvenience you may experience during the upcoming roadworks.

### Reminder - What you will see

- 40mph speed restriction - will start approximately 1.2 miles on the approach to the Black Cat roundabout
- Speed cameras will be in operation to enforce the 40mph speed restriction
- Narrow lanes on A421 on approach to A1 Black Cat
- Temporary road realignment markings
- Workspace safety barriers and roadwork signs

#### Please remember:

- Traffic approaching the closure location shortly before 9pm is likely to be subject to the diversion while the closure is put in place.
- We always try to stick to timings; however, these closures may be amended due to poor weather or operational reasons.
- You can get real-time traffic information via [www.trafficengland.com](http://www.trafficengland.com).

## Map showing location of the road closure and diversion route for A421 closure

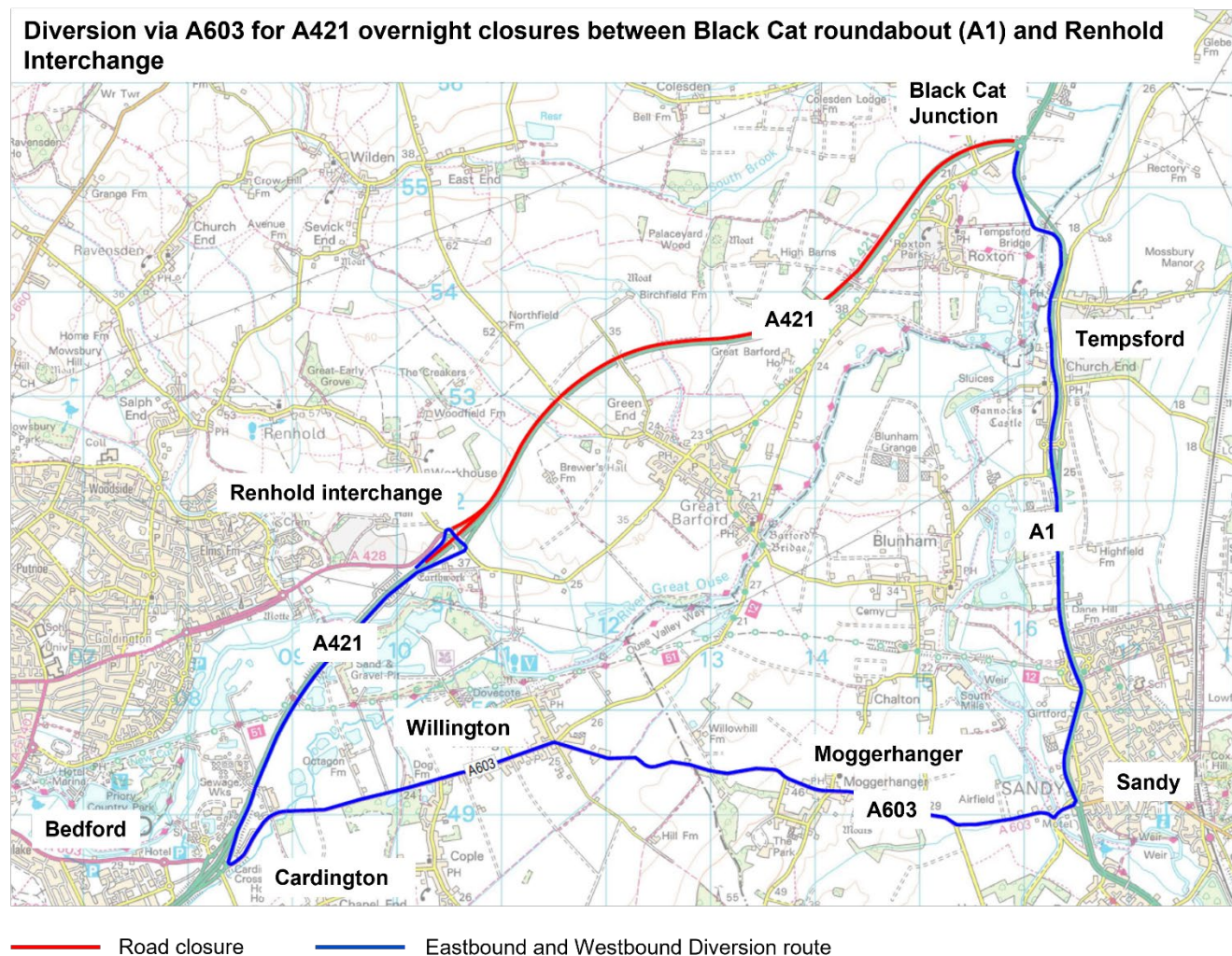

### Keeping you updated

If you'd like more information about this work, then please feel free to contact us by calling the 24/7 National Highways Customer Contact Centre on 0300 123 5000, email [info@a428.co.uk](mailto:info@a428.co.uk)

We invite you to visit our [website](#) to keep up to date with **upcoming and future road closures**

Yours sincerely,  
**The Community Engagement Team**